

CERTIFIED RECORD OF LAND CORNER MONUMENTATION

History of original corner establishment

In 1882, W. Wright subdivided a portion of this township. At this corner point, he set a post, from which:
8" Alder bears N 77° E, 17 links.
10" Alder bears S 18° E, 20 links.
18" Hemlock bears N 77° W, 26 links.
Dug pit in Sec 29, 5 1/2 ft. dist.

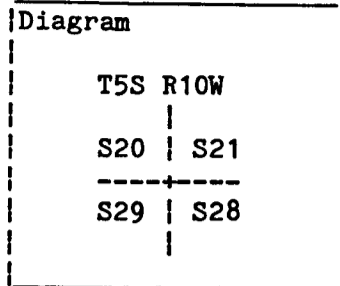

In 1952, W.A. Markham, P.E. 1842, (C.S. #A-546), re-established this corner by double proportion. He set an iron pipe, from which:
5" Alder bears N 40° E, 5.0 ft.
4" Alder bears S 65° E, 33.3 ft.
26" Hemlock bears N 18° W, 81.9 ft.
24" Hemlock bears S 81° W, 109.5 ft. (slope dist.)

In 1968, T. McCullough, L.S. 650, (C.S. #A-1583), found Markham's iron pipe and BT's, and remonumented the iron pipe with a brass cap monument, from which:
12" Alder bears S 69° E, 33.5 ft.
14" Alder bears N 40° E, 5.0 ft.
34" Hemlock bears N 18° W, 81.9 ft.
24" Hemlock stump bears S 83° W, 97.0 ft.
12" Spruce bears S 79° 15' W, 57.7 ft. (new BT)

In 1986, D. Loomis, L.S. 1908, (C.S. #B-1238), determined that Markham used an incorrect procedure to re-establish this corner; he therefore re-established this corner by 3-point control, and set an aluminum cap monument, from which:
6" Hemlock bears S 42 1/4° W, 18.6 ft.
11" Hemlock bears N 39° E, 19.8 ft.
6" Hemlock bears S 66 1/2° E, 7.9 ft.
Reference monument bears S 88° 47' W, 54.6 ft.
McCullough's brass cap monument bears N 85° 50' 54" E, 250.71 ft.

Description of corner evidence found

At the corner point, I find an aluminum cap monument marked as shown:

T5S R10W
S20|S21

S29|S28
LS 1908
1986

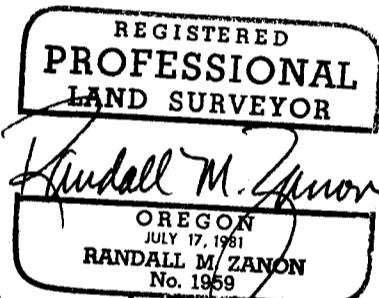

From which the following references:

6" Hemlock bears S 42 1/4° W, 18.6 ft., w/ scribing visible on a double blaze.
11" Hemlock bears N 39° E, 19.8 ft., w/ scribing visible on a double blaze.
6" Hemlock bears S 66 1/2° E, 7.9 ft., w/ scribing visible on a double blaze.
No evidence of the reference monument can be found; the creek has scoured out and wiped out the RM.

Description of monument and accessories I established to perpetuate the original location of this corner

I establish the following new reference monument:

A standard 2 1/2" dia. x 30" long aluminum pipe w/ flared base, with a 3 1/4" dia. aluminum cap marked: "T5S R10W RM N25-20W 41.9 FT. S28 1987 LS 1959" bears S 25° 20' E, 41.9 ft.

Basis of Bearing: Control Traverse from C.S. #B-1238

Magnetic Var: 20° E

Witnesses: Tom McKee
Colin Long
Fred Johnson

Equipment: Topcon GTS-3

Date: February 17, 1987

Office of..... County Surveyor..... County of..... Tillamook, Oregon.....

State of..... Oregon....., I hereby certify that the within instrument was

filed in this office for record on the 11th day of March....., 1987.....

... *Allan E. Duncan* C.S. ... by (DEPUTY)

(COUNTY OFFICIAL)

